

CORPORATION OF THE NATION MUNICIPALITY

BY-LAW No. 49-2021

Being a by-law to designate half load restrictions on municipal roads within the boundaries of The Nation Municipality.

WHEREAS that the provisions of subsections 1, 2, 3, 4 and 7 of Section 122 of the Highway Traffic Act , R.S.O. 1990, Chapter 8 shall apply to all highways under the jurisdiction of The Nation Municipality.

WHEREAS that reduced load period is deemed necessary for the protection of certain highways in The Nation Municipality.

AND WHEREAS, Council deems it necessary to provide for an exemption of a certain road from the reduced load provisions in Schedule A;

THEREFORE, the Council of the Corporation of The Nation Municipality enacts as follows:

1. That the provisions of subsection 7 of Section 122 of the Highway Traffic Act 1990, Chapter 8 as amended shall apply to all highways under the jurisdiction of The Nation Municipality during the period from the 1ST day of March to the 31st day of May, inclusive, in each and every year.
2. This By-Law shall come into effect on the date that the appropriate signs are erected and displayed indicating a reduced load period and the Public Works Director of the Corporation is hereby directed to post said signs with the prescribed time as stated in paragraph 1 of this By-Law, at his discretion. Depending upon the condition of the road, street or highway.
3. That Schedule "B" being portion of municipal roads that the reduced load period does not apply hereto attached be part of this By-Law No. 49-2021.
4. That By-Law No 42-98, 14-99, 45-2003 and 38-2004 be hereby rescinded.
5. That this By-Law shall take effect upon its final passing.

READ A FIRST, SECOND AND THIRD TIME AND PASSED IN OPEN COUNCIL THIS 8th DAY OF MARCH, 2021.

François St-Amour, Mayor

Josée Brizard, CAO-Clerk

CORPORATION OF THE NATION MUNICIPALITY

BY-LAW No. 49-2021

SCHEDULE "A"

The municipal road described below is hereby exempt from the reduced loads period:

EAST SECTOR OF THE MUNICIPALITY

Road Name	From and TO
Concession 21 Road	From Ste-Catherine Street travelling westerly after the entrance of the civic address 3871 in Concession 21 Lots 7 and 8, Concession 20 Reference: Map # 1 - St-Isidore area

WEST SECTOR OF THE MUNICIPALITY

Road Name	FROM AND TO
Calypso Street	From Limoges Road easterly up to the railway Lots 24 to 30, between concessions 3 and 4 Reference: Map # 2 - Limoges area
Pommainville Road	From Calypso Street to Antoine Road Lots 24 and 25, concession 4 Reference: Map # 2 - Limoges area
Innovation Park	From Pommainville Road including Stamp, Joiner and Innovation Roads Lot 24, Concession 4 Reference: Map # 2 - Limoges area

LIMOGES AREA - REDUCED LOAD PERIOD DOES NOT APPLY TO FOLLOWING ROADS

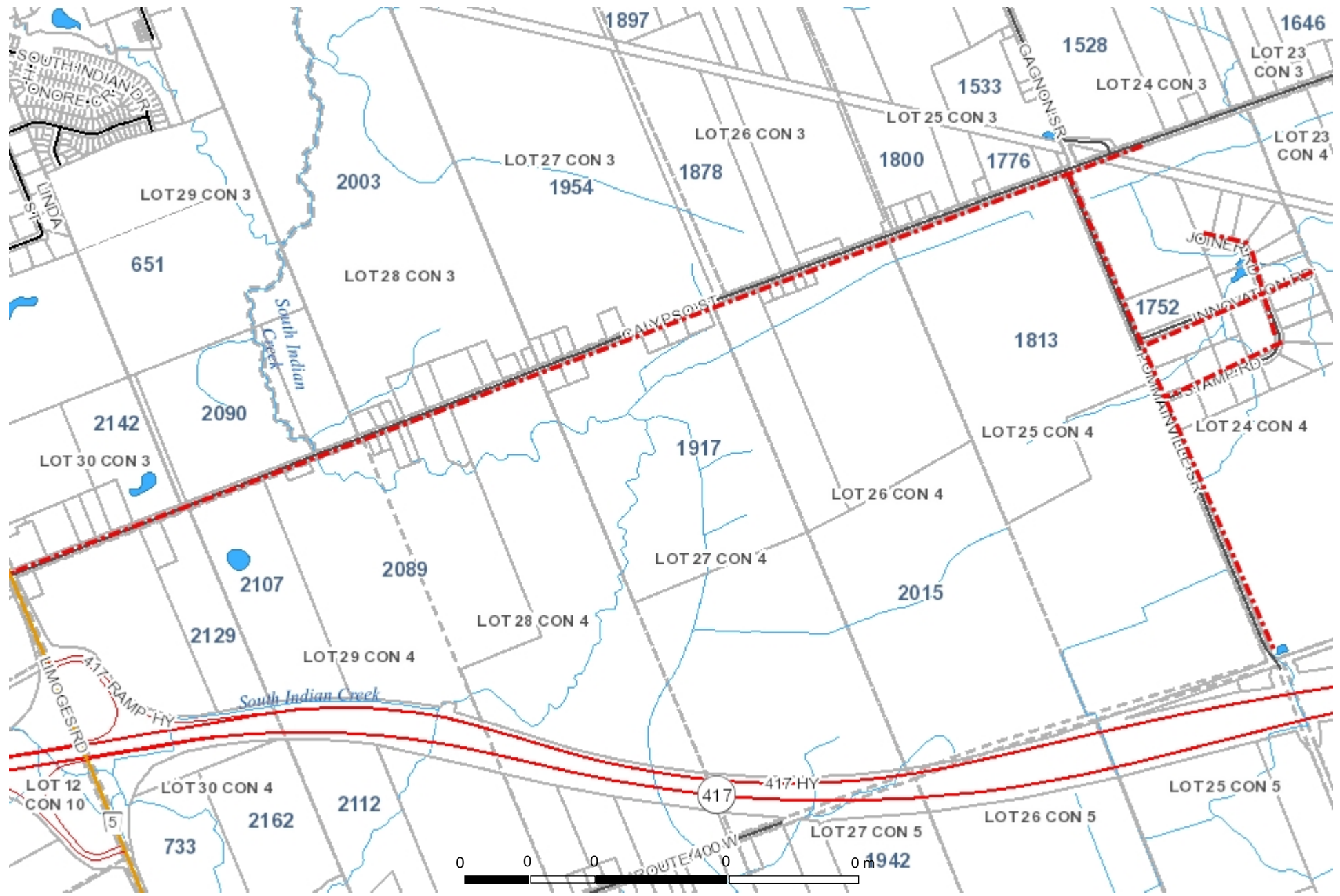

Map generated by UCPR A la Carte web mapping application. The United Counties of Prescott and Russell disclaims all responsibility for errors, omissions or inaccuracies in this publication. Do not rely on it as being a precise indicator of routes or location of features. Produced by UCPR under Licence with the OMNR. © Queen's Printer for Ontario, 2021. © 2021 United Counties of Prescott and Russell, All rights reserved.

March 2, 2021
12:47:56 PM



ST-ISIDORE AREA - REDUCED LOAD PERIOD DOES NOT APPLY TO FOLLOWING ROAD:

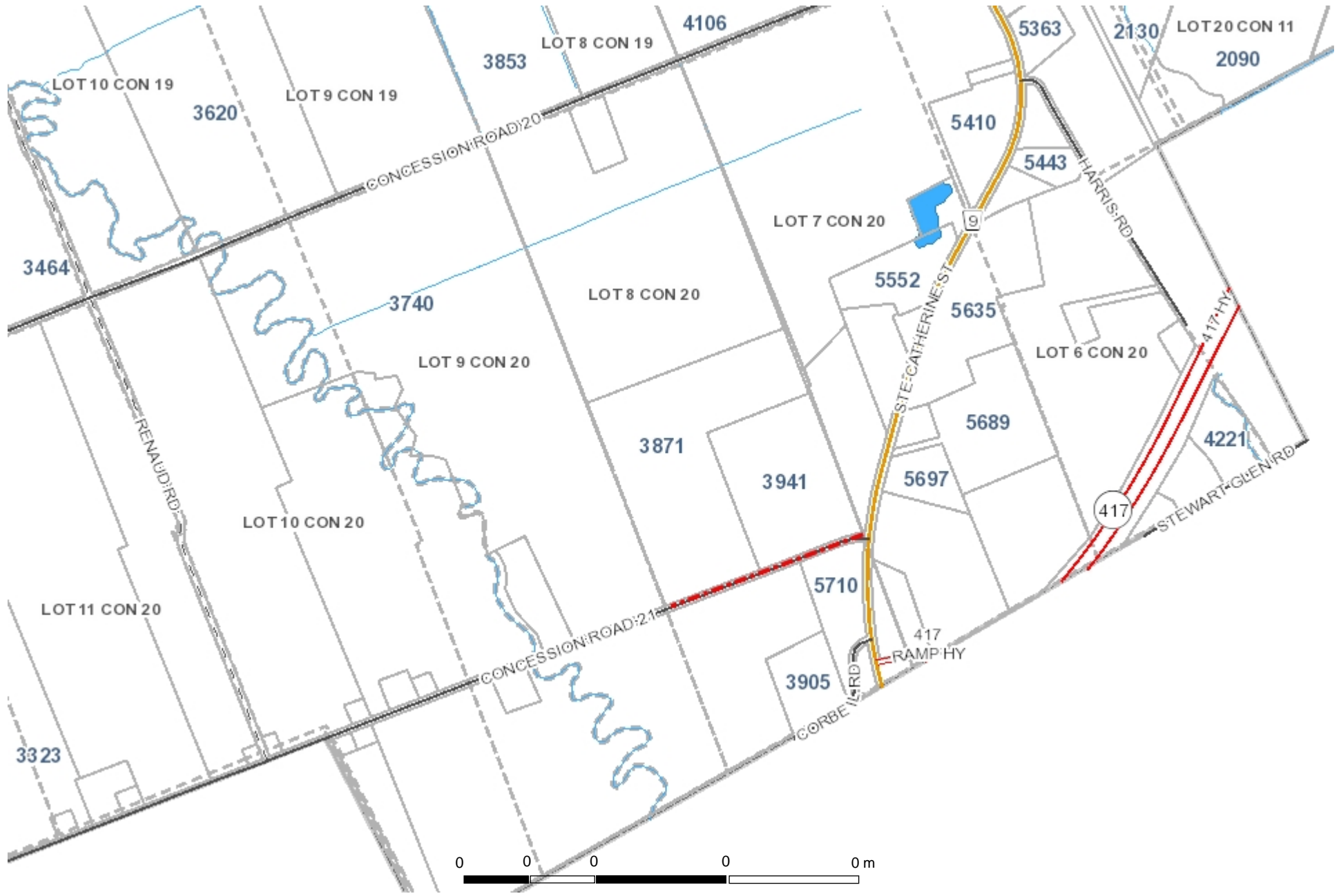

Map generated by UCPR A la Carte web mapping application. The United Counties of Prescott and Russell disclaims all responsibility for errors, omissions or inaccuracies in this publication. Do not rely on it as being a precise indicator of routes or location of features. Produced by UCPR under Licence with the OMNR. © Queen's Printer for Ontario, 2021. © 2021 United Counties of Prescott and Russell, All rights reserved.

March 2, 2021
12:52:33 PM

