

Meeting to Consider

Ranger Drain

Section 78 Report

Presented by Monica Shade, P. Eng.

Overview

- ▶ Purpose of Meeting
- ▶ History
- ▶ Section 78 Initiation
- ▶ Engineer's Report
- ▶ Next Steps

Purpose of Meeting

- ▶ Engineer to present final report;
- ▶ Council gives landowners an opportunity to provide input and ask questions;
- ▶ Council decides if the project should proceed;
- ▶ Council provisionally adopts the Engineer's Report.

Drain History

- ▶ Governing Report: September 23, 1983 (Desjardins/Lascalles Engineering Ltd)
- ▶ Drain originally constructed in 1964-1965 (Stidwill & Associates Ltd)
- ▶ Works completed in 1983 included improvements such as deepening both the Main Drain and Branch 1

- ▶ Ranger Drain serves
 - ▶ Part of Lots 34 to 38, Concession 9 in North Glengarry,
 - ▶ Part of Lots 18 and 19, Concession 10, Champlain, and
 - ▶ Part of Lots 1 to 7, Concession 6, The Nation.

- ▶ Main Drain: 4,230m
- ▶ Branch 1: 1,000m
 - ▶ No changes made to Branch 1

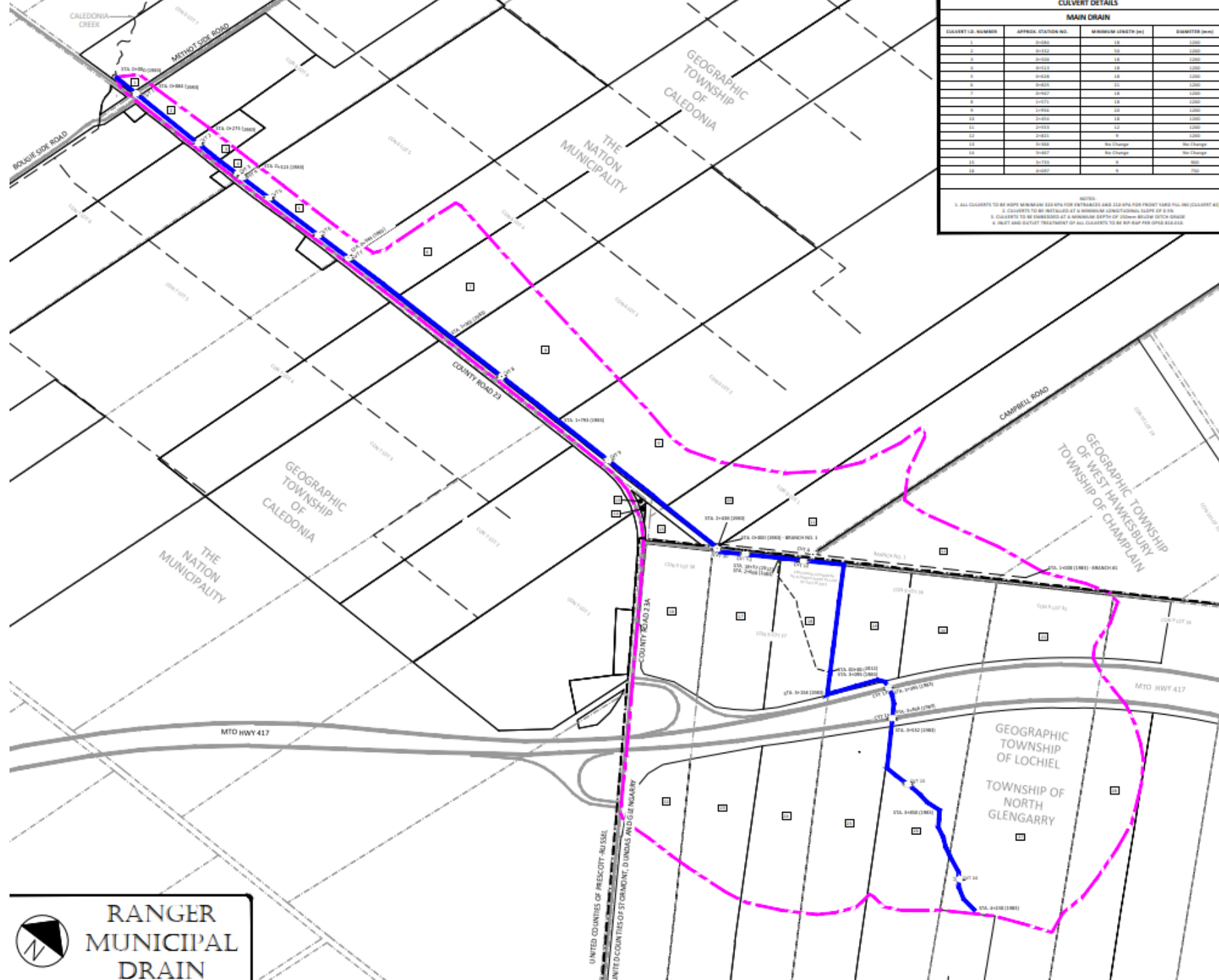

CULVERT DETAILS

CULVERT I.D. NUMBER	APPROX. STATION NO.	MINIMUM LENGTH (m)	DIAMETER (mm)
1	0+00	10	1200
2	0+25	10	1200
3	0+50	10	1200
4	0+75	10	1200
5	0+90	10	1200
6	0+95	10	1200
7	0+97	10	1200
8	1+05	10	1200
9	1+08	10	1200
10	1+10	10	1200
11	1+15	10	1200
12	1+20	10	1200
13	1+25	10	1200
14	1+30	10	1200
15	1+35	10	1200
16	1+40	10	1200
17	1+45	10	1200
18	1+50	10	1200
19	1+55	10	1200
20	1+60	10	1200
21	1+65	10	1200
22	1+70	10	1200
23	1+75	10	1200
24	1+80	10	1200
25	1+85	10	1200
26	1+90	10	1200
27	1+95	10	1200
28	2+00	10	1200
29	2+05	10	1200
30	2+10	10	1200
31	2+15	10	1200
32	2+20	10	1200
33	2+25	10	1200
34	2+30	10	1200
35	2+35	10	1200
36	2+40	10	1200
37	2+45	10	1200
38	2+50	10	1200
39	2+55	10	1200
40	2+60	10	1200
41	2+65	10	1200
42	2+70	10	1200
43	2+75	10	1200
44	2+80	10	1200
45	2+85	10	1200
46	2+90	10	1200
47	2+95	10	1200
48	3+00	10	1200
49	3+05	10	1200
50	3+10	10	1200
51	3+15	10	1200
52	3+20	10	1200
53	3+25	10	1200
54	3+30	10	1200
55	3+35	10	1200
56	3+40	10	1200
57	3+45	10	1200
58	3+50	10	1200
59	3+55	10	1200
60	3+60	10	1200
61	3+65	10	1200
62	3+70	10	1200
63	3+75	10	1200
64	3+80	10	1200
65	3+85	10	1200
66	3+90	10	1200
67	3+95	10	1200
68	4+00	10	1200
69	4+05	10	1200
70	4+10	10	1200
71	4+15	10	1200
72	4+20	10	1200
73	4+25	10	1200
74	4+30	10	1200
75	4+35	10	1200
76	4+40	10	1200
77	4+45	10	1200
78	4+50	10	1200
79	4+55	10	1200
80	4+60	10	1200
81	4+65	10	1200
82	4+70	10	1200
83	4+75	10	1200
84	4+80	10	1200
85	4+85	10	1200
86	4+90	10	1200
87	4+95	10	1200
88	5+00	10	1200
89	5+05	10	1200
90	5+10	10	1200
91	5+15	10	1200
92	5+20	10	1200
93	5+25	10	1200
94	5+30	10	1200
95	5+35	10	1200
96	5+40	10	1200
97	5+45	10	1200
98	5+50	10	1200
99	5+55	10	1200
100	5+60	10	1200
101	5+65	10	1200
102	5+70	10	1200
103	5+75	10	1200
104	5+80	10	1200
105	5+85	10	1200
106	5+90	10	1200
107	5+95	10	1200
108	6+00	10	1200
109	6+05	10	1200
110	6+10	10	1200
111	6+15	10	1200
112	6+20	10	1200
113	6+25	10	1200
114	6+30	10	1200
115	6+35	10	1200
116	6+40	10	1200
117	6+45	10	1200
118	6+50	10	1200
119	6+55	10	1200
120	6+60	10	1200
121	6+65	10	1200
122	6+70	10	1200
123	6+75	10	1200
124	6+80	10	1200
125	6+85	10	1200
126	6+90	10	1200
127	6+95	10	1200
128	7+00	10	1200
129	7+05	10	1200
130	7+10	10	1200
131	7+15	10	1200
132	7+20	10	1200
133	7+25	10	1200
134	7+30	10	1200
135	7+35	10	1200
136	7+40	10	1200
137	7+45	10	1200
138	7+50	10	1200
139	7+55	10	1200
140	7+60	10	1200
141	7+65	10	1200
142	7+70	10	1200
143	7+75	10	1200
144	7+80	10	1200
145	7+85	10	1200
146	7+90	10	1200
147	7+95	10	1200
148	8+00	10	1200
149	8+05	10	1200
150	8+10	10	1200
151	8+15	10	1200
152	8+20	10	1200
153	8+25	10	1200
154	8+30	10	1200
155	8+35	10	1200
156	8+40	10	1200
157	8+45	10	1200
158	8+50	10	1200
159	8+55	10	1200
160	8+60	10	1200
161	8+65	10	1200
162	8+70	10	1200
163	8+75	10	1200
164	8+80	10	1200
165	8+85	10	1200
166	8+90	10	1200
167	8+95	10	1200
168	9+00	10	1200
169	9+05	10	1200
170	9+10	10	1200
171	9+15	10	1200
172	9+20	10	1200
173	9+25	10	1200
174	9+30	10	1200
175	9+35	10	1200
176	9+40	10	1200
177	9+45	10	1200
178	9+50	10	1200
179	9+55	10	1200
180	9+60	10	1200
181	9+65	10	1200
182	9+70	10	1200
183	9+75	10	1200
184	9+80	10	1200
185	9+85	10	1200
186	9+90	10	1200
187	9+95	10	1200
188	10+00	10	1200
189	10+05	10	1200
190	10+10	10	1200
191	10+15	10	1200
192	10+20	10	1200
193	10+25	10	1200
194	10+30	10	1200
195	10+35	10	1200
196	10+40	10	1200
197	10+45	10	1200
198	10+50	10	1200
199	10+55	10	1200
200	10+60	10	1200
201	10+65	10	1200
202	10+70	10	1200
203	10+75	10	1200
204	10+80	10	1200
205	10+85	10	1200
206	10+90	10	1200
207	10+95	10	1200
208	11+00	10	1200
209	11+05	10	1200
210	11+10	10	1200
211	11+15	10	1200
212	11+20	10	1200
213	11+25	10	1200
214	11+30	10	1200
215	11+35	10	1200
216	11+40	10	1200
217	11+45	10	1200
218	11+50	10	1200
219	11+55	10	1200
220	11+60	10	1200
221	11+65	10	1200
222	11+70	10	1200
223	11+75	10	1200
224	11+80	10	1200
225	11+85	10	1200
226	11+90	10	1200
227	11+95	10	1200
228	12+00	10	1200
229	12+05	10	1200
230	12+10	10	1200
231	12+15	10	1200
232	12+20	10	1200
233	12+25	10	1200
234	12+30	10	1200
235	12+35	10	1200
236	12+40	10	1200
237	12+45	10	1200
238	12+50	10	1200
239	12+55	10	1200
240	12+60	10	1200
241	12+65	10	1200
242	12+70	10	1200
243	12+75	10	1200
244	12+80	10	1200
245	12+85	10	1200
246	12+90	10	1200
247	12+95	10	1200
248	13+00	10	1200
249	13+05	10	1200
250	13+10	10	1200
251	13+15	10	1200
252	13+20	10	1200
253	13+25	10	1200
254	13+30	10	1200
255	13+35	10	1200
256	13+40	10	1200
257	13+45	10	1200
258	13+50	10	1200
259	13+55	10	1200
260	13+60	10	1200
261	13+65	10	1200
262	13+70	10	1200
263	13+75	10	1200
264	13+80	10	1200
265	13+85	10	1200
266	13+90	10	1200
267	13+95	10	1200
268	14+00	10	1200
269	14+05	10	1200
270	14+10	10	1200
271	14+15	10	1200
272	14+20	10	1200
273	14+25	10	1200
274	14+30	10	1200
275	14+35	10	1200
276	14+40	10	1200
277	14+45	10	1200
278	14+50	10	1200
279	14+55	10	1200
280	14+60	10	1200
281	14+65	10	1200
282	14+70	10	1200
283	14+75	10	1200
284	14+80	10	1200
285	14+85	10	1200
286	14+90	10	1200
287	14+95	10	1200
288	15+00	10	1200
289	15+05	10	1200
290	15+10	10	1200
291	15+15	10	1200
292	15+20	10	1200
293	15+25	10	1200
294	15+30	10	1200
295	15+35	10	1200
296	15+40	10	1200
297	15+45	10	1200
298	15+50	10	1200
299	15+5		

Section 78 Report - 2024

- ▶ Project initiated as culverts along County Road 23 have reached end of life and are in need of replacement
- ▶ 1983 Engineer's Report specified short culverts (8-12m typical) which given the depth of the ditch result in very steep side slopes and relatively narrow driving surfaces
- ▶ To increase the length of the culverts to meet current standards (and farming needs), a Section 78 process had to be undertaken
- ▶ Like-for-like replacement with the 1983 report was also not possible as the resulting side slopes of the driveways would not comply with current safety regulations.

Previous Consultation

- ▶ An “on-site meeting” was held April 20, 2023 as an opportunity for landowners to present concerns or additional requests for improvement.
- ▶ Meeting was held at the Caledonia Community Centre.
- ▶ Approximately 6 landowners attended to ask questions.
- ▶ No concerns were brought forth with respect to capacity, nor any requests for further improvements to the system.

Engineer's Report (S. 78)

- ▶ Review of culverts along County Road 23 for compliance with Schedule D to By-law 2023-21 (United Counties of Prescott and Russell).
- ▶ Update to lengths of culverts along County Road 23 to meet current agricultural needs.
- ▶ Minor updates to assessment schedule.

Next Steps



Council gives landowners an opportunity to provide input;



Council decides if the project should proceed;



Council provisionally adopts the Engineer's Report;



Clerk circulates the provisional by-law and notice of the sitting of the Court of Revision.

Appeal Opportunities

Court of Revision

- appeals on assessments;

Tribunal

- appeals for technical aspects of the work;

Referee

- appeals on legal aspects of the work.

The background features a dark grey field of 3D question marks. A large, semi-transparent white trapezoidal shape is centered, containing the text. To the right, there are overlapping green geometric shapes in various shades of green, creating a modern, abstract design.

Question Period